

*For high quality treatment of tubular knitted fabric.*

### KNITHYDRO

Continuous hydroextraction minimum tension up to 100m/min Also with : detwisting, alignment of courses and wales, flat feeding, stretching, folding.

#### TREATMENT ON KNITHYDRO

After the fabric is unknit and laid flat, compressed air blows the fabric into a balloon to achieve the alignment of courses and wales. Then a powerful and constant hydroextraction is effected between two rollers. The rate of hydroextraction is constant and reproducible, varying from 60 to 80 % according to speed, water temperature, pressure of the hydroextracting rollers and type of fabric being processed. Magnetic stretcher with wheels and positive feeders compensates for dyeing lengthening and restores the loops to their original pattern. Finally, the fabrics is fed without tension onto a conveyor and folding by the plaiter.

Technical Data	Unit	Single Padder	Double Padder
Working speed unroll	m/min	100	100
Working width	mm	1500	1500
Dimensions :	Length	4260	5400
	Width	2540	2540
Height	mm	5100	5100
	kg	4,000	5,000
Electric power installed	kW	7,6	10
Compressed air consumption	m <sup>3</sup> /h	10	12
Water Consumption	l/h	50 to 500	50 to 500

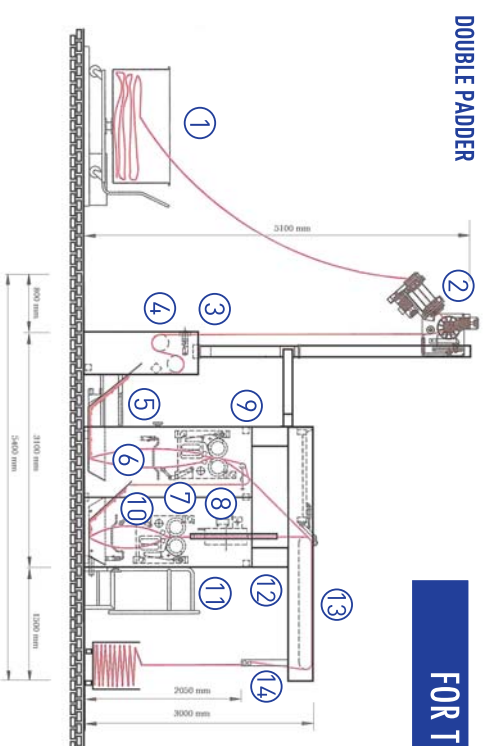

DOUBLE PAPPER

#### Description

1	Turning plate	8	Control and watering bars
2	Twist detection head controlling the turning plate	9	Hydroextraction rollers
3	Hole detection	10	Constant level vat for chemical stuff of impregnation
4	Ring or large wheel stretcher	11	Impregnation rollers
5	Automatic fabric leading device (J-Box)	12	Magnetic stretcher
6	Alignment of courses and wales balloon	13	Transport conveyor
7	Air blower	14	Plaiter

#### SINGLE PAPPER

